

## CU 3300 + CU 3300 basic

POS.	PART NO.	DESCRIPTION
1	30216	Insert plate w/bolt f/drum, right
2	30217	Insert plate w/bolt f/drum, left
3	30222	Adjusting bracket drum
4	30222	Adjusting bracket drum
5	30221	Adjusting bracket motor, left
8	30220	Adjusting bracket motor right
7	30219	Insert plate w/bolt f/motor, left
6	30218	Insert plate w/bolt f/motor, right
15	31025	Left side profile 3300
16	31021	Right side profile 3300
11	31004	Bottom plate 945 mm
12	31046	Top profile 1255 mm, right
12	31047	Top profile 1255 mm, left
13	31014	PVC side protection, 1 m
19	30246	Insert left for unit box 145 mm
9	30215	Belt guide complete (set) - CU/CCU
17	31051	Drum
18	31052	Motor CU/CCU incl plug
14	30245	Insert right for unit box 80 mm
21	31059	Connection piece fork protection
22	31008	Bottom plate 2135 mm with holes
23	31044	Top profile 2345 mm
25	31060	Connection piece

POS.	PART NO.	DESCRIPTION
10	32001	Connection piece
10	31011	PVC belt 3300
10	32000	PVC belt 3300 20 mm, cleats
10	32009	PVC belt 3300 40 mm, cleats
10	32013	PVC belt 3300 60 mm, cleats
10	32017	PVC belt 3300 20 mm, V-chevron cleats
10	32021	PVC belt 3300 40 mm, wavy edge cleats
	50340	Rubberwheel (1 pc) for undercarriage
	30213	Catch for undercarriage and for hopper
20	31081	CU unit 240V basic
20	31085	CU unit 110V basic
20	31080	CU unit 240V
20	31084	CU unit 110V
	32204	CU unit 240V basic - renovated
	32205	CU unit 110V basic - renovated
	32200	CU unit 240V - renovated
	32202	CU unit 110V - renovated
	30229	Emergency stop, complete
	30232	Changeover forwards/backwards switch
	30234	Potentiometer/speed controle, complete
	30227	CU/CCU plug IN
	30228	CU/CCU plug OUT
	30235	Miniature fuse 63mA for CU/CCU unit
	30250	Frictionband for engine
	30053	CU/CCU connection cable, 7 m
	50105	Adapter cable 240V 10A w/CEE and Schuko plug

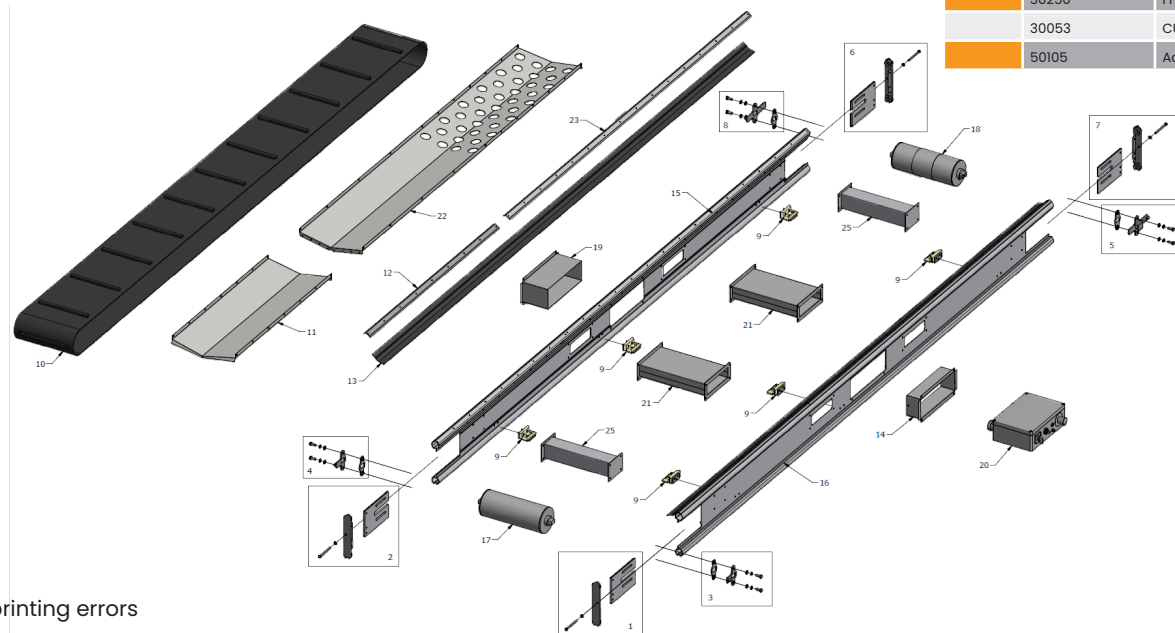

Subject to printing errors